

PoE Power Injector

30W Series



Single Port Multi-Gigabit 30W Data Sheet

For the latest revision, please visit power.liteon.com

Description

This product is an indoor AC to DC power over ethernet (PoE) injector. It can provide 30W output power with a constant 54Vdc main voltage source. It is built-in a LED to identify injectors that is in normal state.

Features

- * Full AC input voltage design with C14 socket
- * IEEE 802.3at standard
- * IEEE 802.3at backward compatible
- * 10Gbps Data Rates with Cat6a shielded Cable.
- * Automatic detection and protection of non-standard Ethernet terminals
- * IEC/EN 62368-1 design compliance
- * Energy efficiency level VII compliance
- * High reliability and high lightning surge ability



Electrical Specification

| Model Name | PA-1300-86LV-TG |
|----------------------------|---|
| Output | |
| Rated power | 30W |
| Rated voltage | 54Vdc |
| Rated current | 0.555A |
| Ripple & Noise(max.) | Ripple (scale 10ms) $\leq 500\text{mV}_{PP}$ Noise (scale 10us) $\leq 200\text{mV}_{PP}$ |
| Line & load regulation | 50V~57V |
| LED Behavior | Solid Green – Power good and output “ON” ; One for PoE connection (green) |
| Input Specification | |
| Input voltage range | 90Vac~264Vac, |
| Current range (max.) | 1A @ 90Vac, |
| Inrush current (typ.) | 100A, at 230VAC, cold start@25°C and full load |
| Frequency range | 47-63Hz |

| | |
|-----------------------------|---|
| Leakage current (max.) | 0.5mArms at 264Vac |
| Efficiency | DOE VII |
| Protection Function | |
| Over voltage (max.) | 60V, Auto recover |
| Over current (max.) | One port <0.75A, Auto recover |
| Short circuit at O/P | Auto recover |
| Over temperature | Auto recover |
| Others | |
| Cooling fan | Natural cooling, no fan design |
| MTBF (min.) | > 200,000 hours at 25°C typical load |
| Environment | |
| Temperature | (Operating) -10~40°C / (Storage) -20~70°C |
| Humidity | (Operating and Storage) 5~90% RH non-condensing |
| Altitude (max.) | 5000 meters |
| Mechanical | |
| Dimension | 106(L)*70(W)*35(H) |
| Package Vibration Test | Follow ISTA-2A Standard |
| Weight (typ.) | 156 +/-5g |
| Safety | |
| Standard | CB/IEC62368-1,TUV62368-1,UL62368-1,EN62368-1, CCC GB4943.1,PSE J62368-1,BSMI CNS15598-1,KC62368-1 |
| Dielectric Strength | Primary to Secondary: 4242VDC/3000VAC for 1 minute Primary to Field Ground: 2121VDC/1500VAC for 1 minute |
| Insulation resistance(min.) | Primary to Secondary: >10M ohm 500VDC Primary to Field Ground: >10M ohm 500VDC |
| EMC | |
| EMI | EN55032, EN55035 Class B, FCC Part 15 Class B, VCCI Class B |
| ESD | EN55035 ; IEC 61000-4-2 Level 4, criteria A Air: +/-15KV Contact: +/-8KV |

| | |
|---|--|
| Radiated (RS) | EN55035 ; IEC 61000-4-3 Level 2, criteria A (3V/m: 80MHz-1000MHz, 1800MHz, 2600MHz, 3500MHz, 5000MHz) |
| EFT | EN55035 ; IEC 61000-4-4 Level 2 +/-1kV(5kHz or 100kHz) for AC mains, criteria A +/-0.5kV(5kHz) for PoE output and Data input ports, criteria B |
| Surge | EN55035; IEC 61000-4-5 For AC mains, criteria A: +/-4KV, line to line (differential mode) +/-4KV, line to earth GND (common mode) For PoE output, criteria B: +/-6KV, line to earth GND |
| Conducted (CS) | EN 55035 ; IEC 61000-4-6 Level 2, criteria A (3Vrms AM 80% 0.15MHz - 10MHz ; 3Vrms to 1Vrms 10MHz-30MHz ; 1Vrms 30MHz-80MHz) |
| Power Frequency Magnetic Field | EN 55035 ; IEC 61000-4-8 Level 1 (1A/m), criteria A |
| Voltage dips/interruptions | EN 55035 ; IEC 61000-4-11 Class 3 |
| Harmonic Current Emission (for power rating >75w PSU) | EN 61000-3-2 Class A |
| Voltage Fluctuation and Flicker | EN 61000-3-3 |

Mechanical Specification

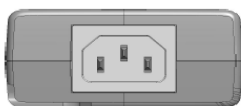
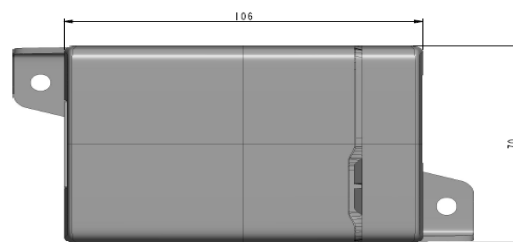

Dimensions (L x W x H)
Weight
Input Connector
Data In/Output Connector

106mm x 70.0mm x 35.0mm
200~300g
IEC320 C14
Shielded RJ45